

# Installation and Maintenance Instructions

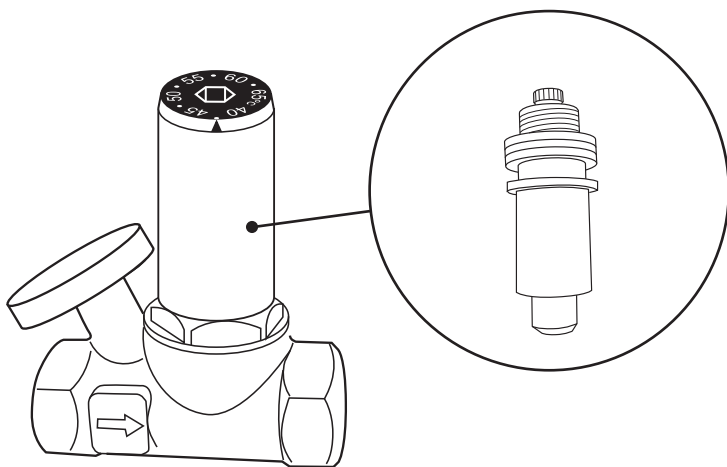

## Installing the Reliance Valves Thermal Balancing Valve Service Kit



Part Number: SKIT100060



For valve models: TREG100060,  
TREG100065, SBTREG100060,  
SBTREG100065, TREG200001 &  
TREG200002.

## Installation Instructions:

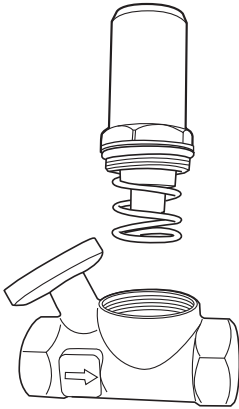

Isolate valve and remove head from Valve.

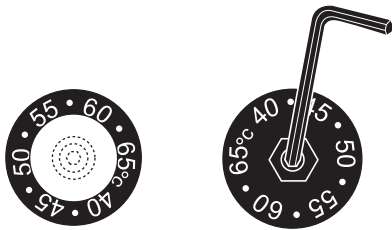

Remove clear plastic cap from the top of the headwork, take a 2.5mm Allen key and remove the screw from the top of the headworks, then lift off the temperature indicator.



Then remove the insert from the spindle housing. Please note that this could be tight and might need grips to help remove.

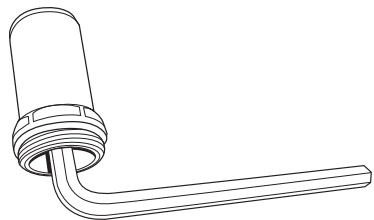

Use an 8mm Allen key to remove the internal from the headworks (Spindle Housing)

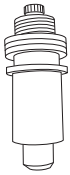

New internals



New spindle insert

Take the new spindle from the packaging and fit the small O-ring before inserting into the housing using the 8mm Allen key.  
(Apply lubricant to O-ring)

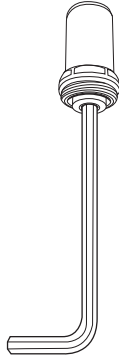
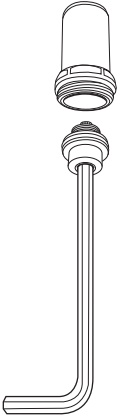

Then wind the spindle all the way into the spindle housing until it reaches the end of the range.

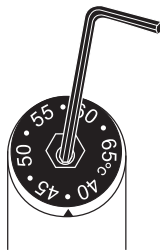
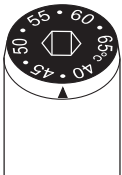

This will ensure that the valve is calibrated. Align the laser-marked arrow on the spindle housing with the midpoint indicator between 40-45°C (the minimum temperature).

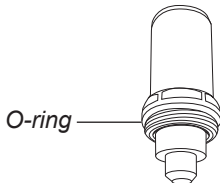

Then reassemble the Headworks as shown left.

Remember to change the O-ring on the housing.

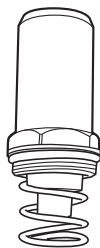

Complete headworks

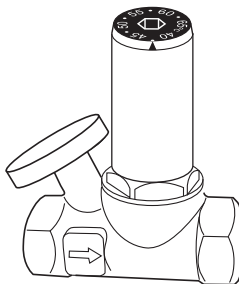

Then reassemble the valve.



Once the Headworks and valve body have been reassembled, set the temperature using the 8mm Allen key,

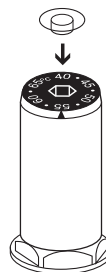

and finally, replace the clear plastic cap.



[reliancevalves.com](http://reliancevalves.com)

Reliance Worldwide Corporation (UK) Ltd  
Horton Rd, West Drayton UB7 8JL  
(+44) (0) 1895 449233

Reliance Worldwide Corporation (UK) Ltd reserves the right to make changes to the product which may affect the accuracy of information contained in this leaflet.

Issue 001\_0324