

Tenant Valve Compact

Installation and maintenance
instructions

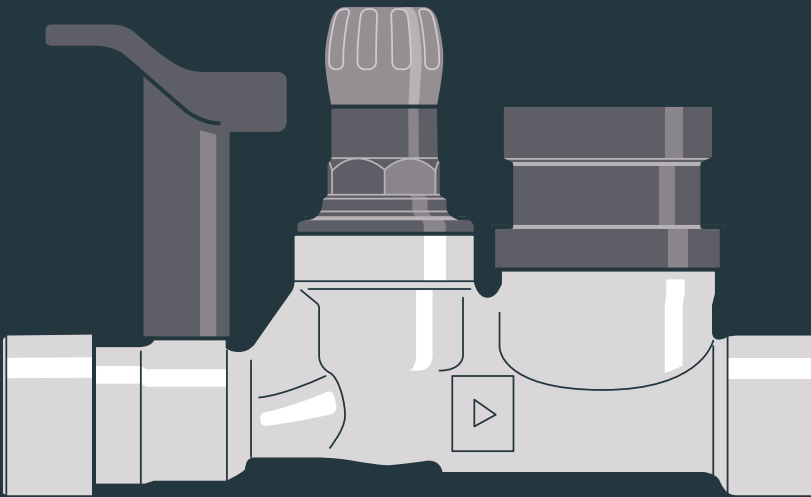

A space saving, compact combination
valve, ideal for apartment blocks
and multi-occupancy buildings.



Contents

1. General information	4
2. Working parameters and specifications	4
3. Dimensions	5
4. Installation	6
5. Commissioning	7
6. Maintenance	8
7. Replacing the check valve	9
8. Spares & accessories	10

1. General information

The Tenant Valve Compact combines a number of functions in one compact self-contained unit to control and monitor water supply to multi-occupancy buildings, such as flats or offices. Its single unit cartridge design ensures a quick and easy installation with reduced leakage potential and simple future maintenance, saving time and costs.

The Tenant Valve Compact incorporates a ball type isolating valve, approved as a stop valve by water regulations (WRAS), a pressure reducing valve (PRV) with integral strainer for protection of the complete installation, double check valves in a removable housing, and a patented pressure gauge displaying both upstream and downstream pressures.

All components are accessible from one side of the valve, which comes supplied with a moulded insulation cover.

- Single unit cartridge design ensures a quick and easy installation, reduced leakage potential and easy maintenance
- For use up to 16 bar inlet pressure and temperatures up to 65°C
- Adjustable between 1.5 - 6 bar
- Supplied complete with a moulded insulation protection box
- Easy to service integral strainer within the PRV provides added protection to occupants and the plumbing system

2. Working parameters and specifications

Maximum inlet pressure	16 bar
Outlet adjustable pressure	1.5 - 6 bar
Pre-set pressure	4 bar
Maximum temperature	65°C
Suitable media	Potable water
Mounting position	Horizontal or vertical

3. Dimensions

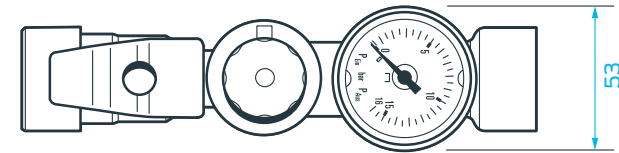
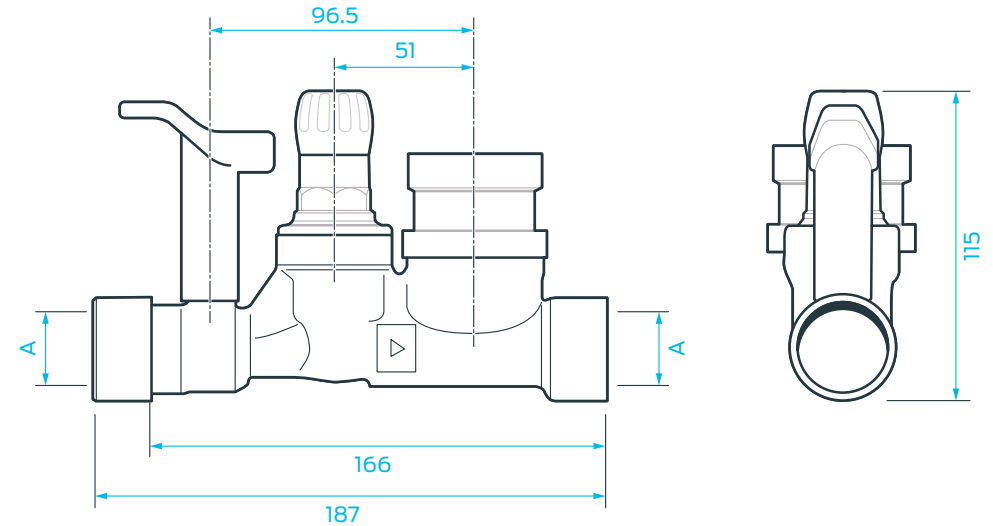

	TVAP250050	TVAP250055
A	3/4"	1"

All dimensions in mm unless otherwise stated.

4. Installation

This installation guide is provided to give instruction on the best installation practices that should be observed to ensure the correct functioning of the Tenant Valve Compact. Failure to comply with these instructions will result in the warranty becoming invalid.

Before installation of the Tenant Valve Compact, ensure that the designation of the valve matches the application. The operating parameters must be within limits stated, system flushed free of debris and suitable access available to allow for maintenance of the pressure reducing valve.

The Tenant Valve Compact is water regulations approved as an above ground stop valve, so there is no requirement to install an additional isolation valve prior to the valve assembly. The double check valve housing at the outlet end means there is no requirement for isolation valves after the assembly and all maintenance can be carried out without the need for draining down the system. If desired, an optional outlet isolating valve and drain off combination valve is available (part codes – ¾" TABV250001, 1" TABV250005.)

Please ensure you do not put the valve under any undue stress in the pipework, it should be installed in a frost protected location with easy access.

The Tenant Valve Compact can be installed in any orientation as long as the flow is in the correct direction, as indicated by the arrows on the body of the valve. Use suitable connections in the inlet and outlet ports of the valve so they are water tight.

The minimum pipe length downstream of the pressure reducing valve, before any elbow is fitted must be no less than five times the pipework size. Eg. DN25 would equal 5" distance. This is to protect against noise and to ensure a laminar flow.

Note: Any use of jointing compound is not recommended as any residue material not thoroughly flushed out of the system could cause the product to malfunction and void the product warranty.

5. Commissioning

Note: The valve should only be adjusted when under no flow conditions. Also ensure that the inlet pressure is at least one bar higher than the desired outlet pressure.

Adjusting the set pressure on the valve

- 1 Pull the red adjustment knob upwards to unlock the pressure reducing cartridge.
- 2 Turn the adjustment knob anti-clockwise to decrease the outlet pressure down to it's minimum setting.

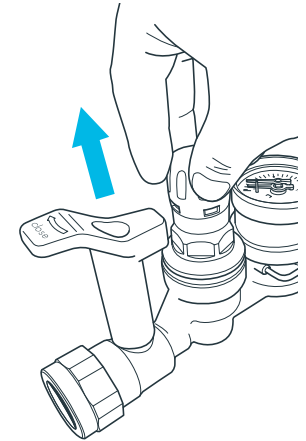
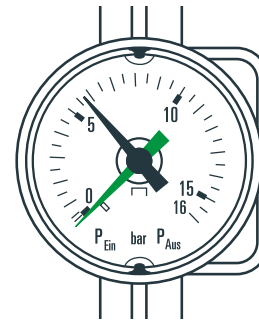

- 3 Open a tap downstream of the pressure reducing valve to relieve the excess pressure for a couple of seconds. The dual reading pressure gauge should now show the incoming pressure (black needle) and the reduced outlet pressure (green needle).

- 4 To increase the pressure, turn the adjustment knob clockwise and watch the outlet pressure increase on the gauge.

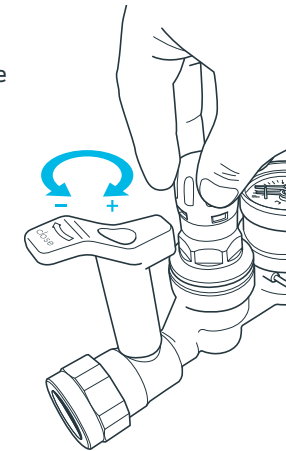
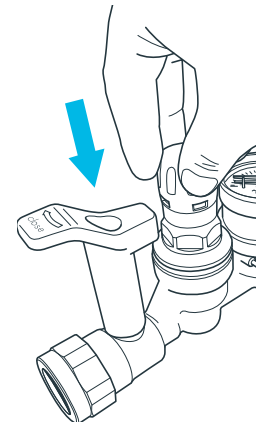

- 5 When the desired outlet pressure is reached, push the knob downwards to lock it into place.

6. Maintenance

To service the integral strainer located at the base of the PRV Cartridge:

- 1 Isolate the water supply using the integral isolation valve then open a tap downstream of the Tenant Valve Compact to relieve the excess pressure.
- 2 Use a spanner on the base of the cartridge to unscrew it. Once loose, you can remove the cartridge from the brass body.
- 3 The strainer can easily be removed by sliding it off the end of the cartridge.

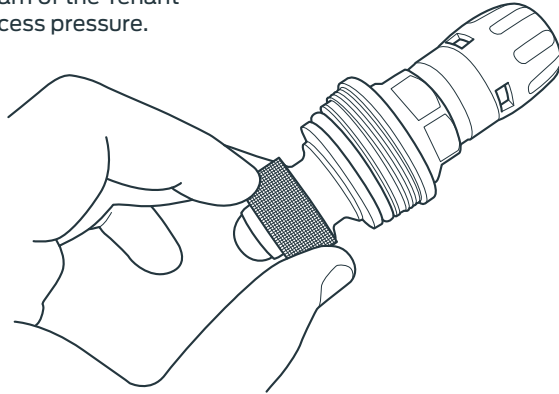

- 4 Rinse the strainer under clean running water until any debris has been washed away.
- 5 Replace the strainer onto the end of the cartridge.
- 6 Re-insert the pressure reducing valve cartridge into the brass body.
- 7 Using a spanner, screw the cartridge back into the valve body.

Please note: The set outlet pressure is not altered by this operation.

7. Replacing the check valve

In the Tenant Valve Compact, there are two check valves in parallel on the downstream side of the water meter connection port. If the check valve cartridges are damaged in service, they must be removed and replaced.

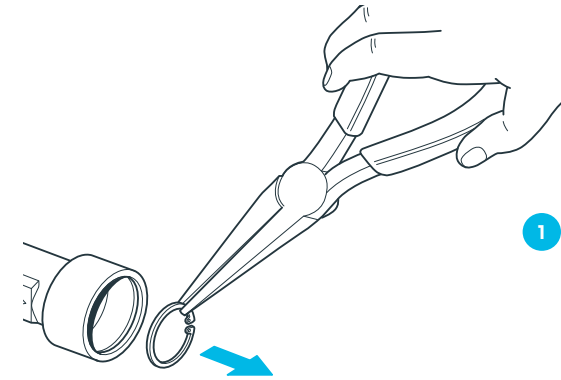

- 1 To replace the check valves, firstly release the circlip using a pair of long-nose pliers.

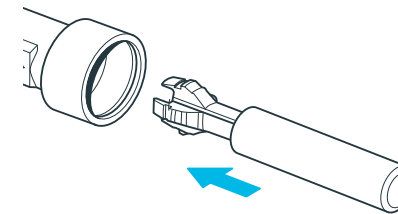

- 2 Insert the maintenance key, supplied with the new check valve cartridges, until it snaps into the check valve.

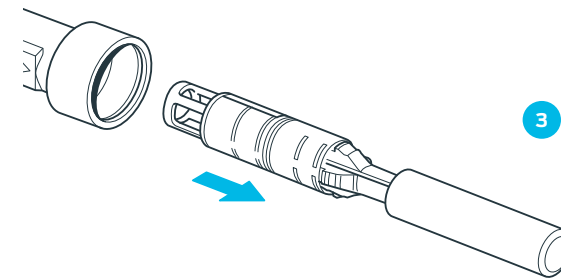

- 3 Pull the check valve assembly out of the Tenant Valve Compact and replace for new.



**Reliance Worldwide
Corporation (UK) Limited**

Horton Road
West Drayton
UB7 8JL
United Kingdom
Tel: +44 (0) 1895 449233

reliancevalves.com

Reliance Worldwide Corporation (UK) Limited reserves the right to make changes to the product which may affect the accuracy of information contained in this leaflet.

Manufactured & distributed by
Reliance Worldwide Corporation.

AN RWC BRAND
RWC