

# Easetet® 320 Series Pressure Reducing Valve (Cold and Hot)

**Compact pressure reducing valve for reducing high hot and cold water pressure to a safer lower outlet pressure (adjustable between 1.0 - 6.0 bar)**

## Overview

Reliance Valves Easetet 320 Series are a range of high-quality pressure reducing valves designed for domestic applications up to 16 bar and 45°C, with an easy-to-use 'Lift & Turn' adjustment mechanism.

The valve features a single gauge port on the base of the valve, as well as integrated drop tight valve to control the pressure under both flow and no-flow conditions.

All working components are contained in a one-piece cartridge and can be installed in any orientation for quick and easy installation. Available with MBSP connections with union fittings or SharkBite push-fit connections for fast and simple installation.

## Features & benefits

- High flow rate design
- 'Lift & Turn' mechanism for easy tool-free pressure adjustment
- Single gauge port on the base of valve
- Fully serviceable strainer
- Drop tight valve controls pressure under flow and no-flow conditions
- One-piece cartridge can be installed in any orientation
- A variety of connection ends depending on installation needs
- Suitable for hot and cold water use only
- MBSP connections with unions is suitable for copper pipe only. The SharkBite push-fit version is suitable for Speedfit PEX and polybutylene barrier pipe (inserts required) or copper pipe

## Standards & approvals

WRAS Approved

DVGW

BS EN 1567



Product code	Size	Product code	Size
<b>Cold water up to 45°C</b>		<b>Hot water up to 80°C</b>	
PRED320001	½" FBSP	PRED320050	½" FBSP
PRED320003	½" MBSP union	PRED320051	½" MBSP union
PRED320005	¾" FBSP	PRED320055	¾" FBSP
PRED320010	15mm compression	PRED320056	¾" MBSP union
PRED320011	¾" MBSP union	PRED320060	15mm compression
PRED320015	22mm compression	PRED320065	22mm compression
SBPRED320001	15mm push-fit	SBPRED320050	15mm push-fit
SBPRED320005	22mm push-fit	SBPRED320055	22mm push-fit



# Easet 320® Series Pressure Reducing Valve (Cold and Hot)

## Specifications

Maximum working pressure	16.0 bar
Adjustable set pressure	1.5-5.5 bar
Pressure reduction ratio	10:1
Maximum working temperatures	
Cold water versions	45°C
Hot water versions	80°C

## Materials

Body	DZR brass
Internal components	DZR brass
Seals	EPDM and NBR
Spring	Zinc plated spring steel
Strainer	Stainless steel
Diaphragm	EDPM
Cover	Glass filled nylon polymer

## Flow rates

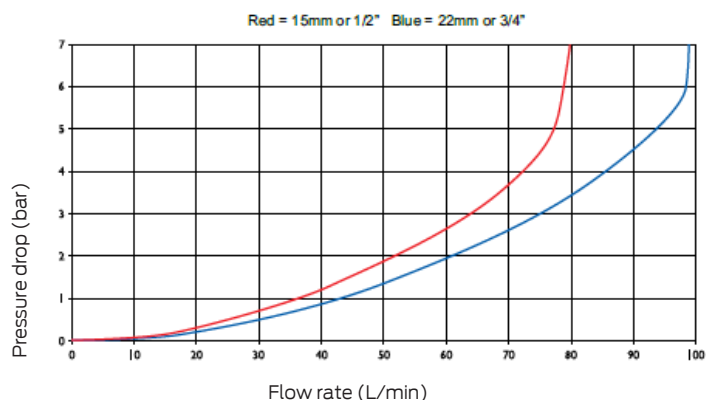

Product code	A	B	C	D	E
PRED320001 / PRED320050	1/2"FBSP	97	72	42	1/4" FBSP
PRED320005 / PRED320055	3/4"FBSP	97	74	42	1/4"FBSP
PRED320003/PRED320051	1/2"MBSP union	97	130	42	1/4"FBSP
PRED320011/PRED320056	3/4"MBSP union	97	142	42	1/4"FBSP
PRED320010/PRED320060	15mm comp	97	86	42	1/4"FBSP
PRED320015 / PRED320065	22mm comp	97	88	42	1/4"FBSP
SBPRED320001 / SBPRED320050	15mm push-fit	97	131	42	1/4"FBSP
SBPRED320005/SBPRED320055	22mm push-fit	97	143	42	1/4"FBSP

## Dimensions – All measurements in mm unless otherwise stated

FBSP models

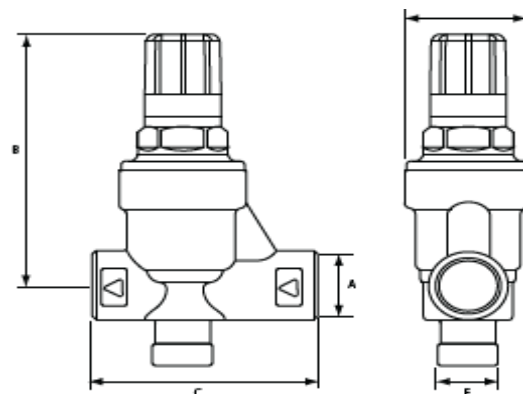

MBSP models

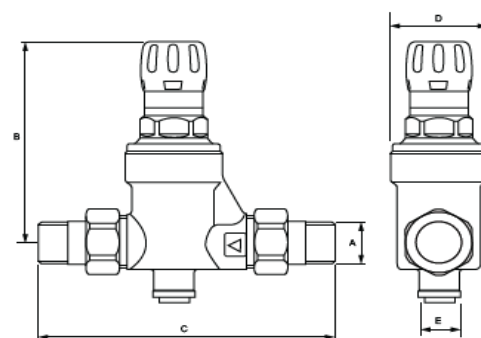

Compression models

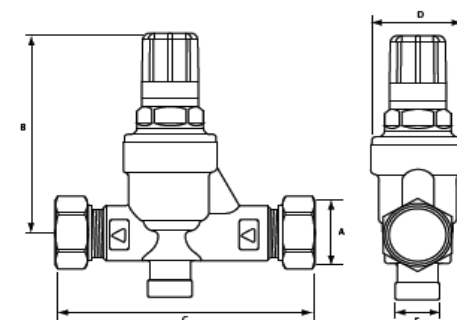

Push-fit models

