

Floguard® Double Check Valves

Brass slimline double check valve for Fluid Category 3 contamination risks.

Overview

Reliance Valves Floguard Double Check Valves protect against the risk of backflow and back siphonage contamination. The compact and lightweight valves are ideal for all class 3 contamination risks as per Water Supply (Water Fittings) Regulations 1999.

Double check valves contain two valves so that if one valve fails, the other acts to prevent backflow and contamination in the mains water supply. The valves contain a check cartridge that under normal conditions is held closed by pressure within the system. When vacuum conditions occur, the suction causes the check cartridge to open and air to flow through, equalising the pressure within the hot water heater.

Features & benefits

- Double check valves protects against the risk of backflow and back siphonage contaminations
- Compact lightweight construction for easy installation
- Minimum pressure drop offer good flow rates
- Available with FBSP and compression connections
- Suitable for hot and cold water use only
- Compatible with copper pipe only

Specifications

Working pressures	0.1 bar min / 16.0 bar max
Maximum temperature	85°C

Standards & approvals

BS EN 13959

WRAS Approved



Dimensions – All measurements in mm unless otherwise state

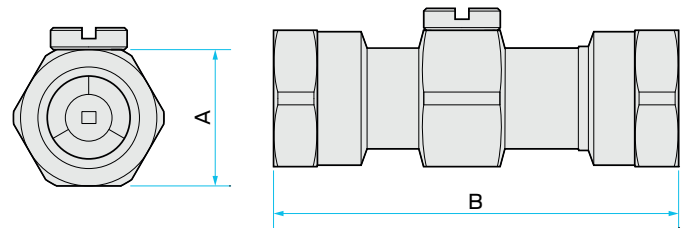
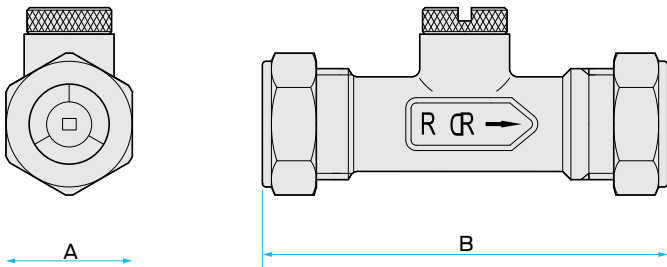

Product code	Description	Size	A	B
FLOW230001	Single check valve, DZR brass	15mm	24	82
FLOW230002	Single check valve, DZR brass	15mm	24	82
FLOW230003	Single check valve, DZR brass	22mm	32	87
FLOW230004	Single check valve, DZR brass	28mm	38	115
FLOW230005	Single check valve, DZR brass	½" FBSP	25	75
FLOW230006	Single check valve, DZR brass	¾" FBSP	31	87
FLOW230007	Single check valve, DZR brass	1" FBSP	38	101
FLOW230008	Single check valve, DZR brass	1 ¼" FBSP	46	121
FLOW230009	Single check valve, DZR brass	1 ½" FBSP	52	143
FLOW230010	Single check valve, DZR brass	2" FBSP	65	184

Materials

Body	DZR brass
Seals	EPDM
Check cartridges	Acetyl copolymer
Spring	Stainless steel

How to specify

The double check valve must be WRAS approved and conform to BSEN 13959 supplied in Brass with FBSP or compression type connections, to protect against backflow and back-siphonage Class 3 contamination risks, rated to 16 bar with a minimum working pressure of 0.1 bar.

